

\$52,500 - 22 64060 Twp Rd 442, Rural Wainwright No. 61, M.D. of

MLS® #A2125213

\$52,500

0 Bedroom, 0.00 Bathroom,
Land on 2.33 Acres

NONE, Rural Wainwright No. 61, M.D. of,
Alberta

MOTIVATED SELLER! Listed below appraised value!! Take a look at this 2.33 acre lot at Banjo Estates. Lot 18 is located a quick drive south of Wainwright in a great subdivision. Enjoy acreage life while still close to all the amenities that Wainwright has to offer! Services are easily accessed but have not been brought onto the lot. Donâ€™t pass this by! 2.33 acres for such a great price!!

Essential Information

MLS® #	A2125213
Price	\$52,500
Bathrooms	0.00
Acres	2.33
Type	Land
Sub-Type	Residential Land
Status	Active

Community Information

Address	22 64060 Twp Rd 442
Subdivision	NONE
City	Rural Wainwright No. 61, M.D. of
County	Wainwright No. 61, M.D. of
Province	Alberta
Postal Code	T9W 1T4

Additional Information

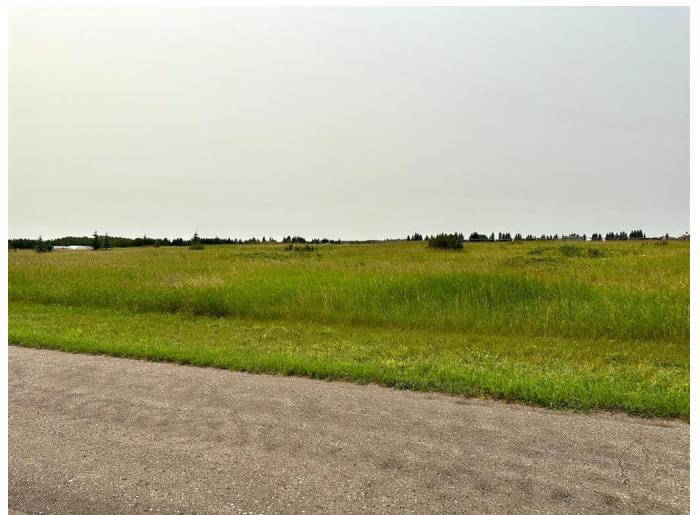

Date Listed	April 19th, 2024
Days on Market	373
Zoning	CR

Listing Details

Listing Office	COLDWELLBANKER HOMETOWN REALTY
----------------	--------------------------------

Data is supplied by Pillar 9â„¢ MLS® System. Pillar 9â„¢ is the owner of the copyright in its MLS® System. Data is deemed reliable but is not guaranteed accurate by Pillar 9â„¢. The trademarks MLS®, Multiple Listing Service® and the associated logos are owned by The Canadian Real Estate Association (CREA) and identify the quality of services provided by real estate professionals who are members of CREA. Used under license.