

\$250,000 - 33 Waterton Ridge Drive, Rural Cardston County

MLS® #A2209197

\$250,000

0 Bedroom, 0.00 Bathroom,
Land on 7.46 Acres

NONE, Rural Cardston County, Alberta

If you're looking for a quiet, serene peace of paradise to call your own and build your future dream home on look no further! This property, overlooking Payne Lake, is located just 15 minutes from Waterton Lakes National Park, 20 minutes to the town of Cardston, and 30 minutes to nearest the United States border crossing! It even has 100 AMP electrical service to the property already! Around Payne Lake you and your family can enjoy fishing, gorgeous hikes, kayaking/canoeing, camping, and so much more!! If you're looking for the perfect recreational property to get out of the hustle and bustle of city life, call your REALTOR® and book your showing today!

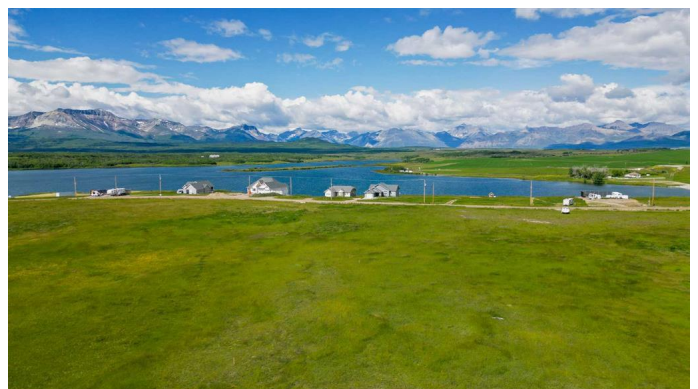
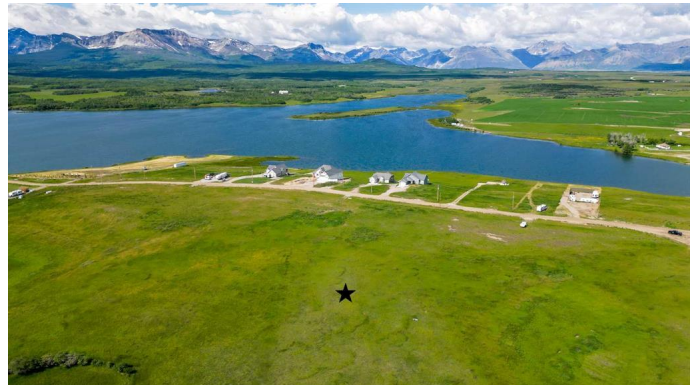

Essential Information

MLS® #	A2209197
Price	\$250,000
Bathrooms	0.00
Acres	7.46
Type	Land
Sub-Type	Residential Land
Status	Active

Community Information

Address	33 Waterton Ridge Drive
Subdivision	NONE
City	Rural Cardston County

County	Cardston County
Province	Alberta
Postal Code	T0K 1N0

Additional Information

Date Listed	April 7th, 2025
Days on Market	119
Zoning	GCR

Listing Details

Listing Office	Grassroots Realty Group
----------------	-------------------------

Data is supplied by Pillar 9â„¢ MLS® System. Pillar 9â„¢ is the owner of the copyright in its MLS® System. Data is deemed reliable but is not guaranteed accurate by Pillar 9â„¢. The trademarks MLS®, Multiple Listing Service® and the associated logos are owned by The Canadian Real Estate Association (CREA) and identify the quality of services provided by real estate professionals who are members of CREA. Used under license.