

\$195,000 - 1074, 67325 Churchill Park Rd, Lac La Biche County

MLS® #A2210631

\$195,000

0 Bedroom, 0.00 Bathroom,
Land on 0.47 Acres

Lakeview Estate_LLBC, Lac La Biche County,
Alberta

Discover the potential of this beautiful .47-acre treed lot in the quiet Lakeview Estates subdivision, just a 5-minute drive from the town of Lac La Biche. This country residential parcel offers the perfect opportunity to build your dream home or getaway retreat in a peaceful setting near Lac La Biche Lake, the golf course, and Churchill Park Island. Located at 1074 Churchill Park Road, this lot is adjacent to another available parcel (1070), giving buyers the unique option to purchase both and create nearly a full acre of space to enjoy. All services are available in Lakeview Estates with the water and sewer paid for to the property line. Sir Winston Churchill Park is a bike ride away or 3 minutes by car and has amenities like cabin rentals, camping, a beautiful lakefront hall and a great boat launch for quick boat access. Whether you're planning to build now or hold as an investment, this lake-area lot offers natural beauty, convenience, and potential. Lac La Biche has been popular destination camping, world class fishing and recreational lake as well as backcountry recreational activities including Lakeland Provincial Park only 20 minutes away.

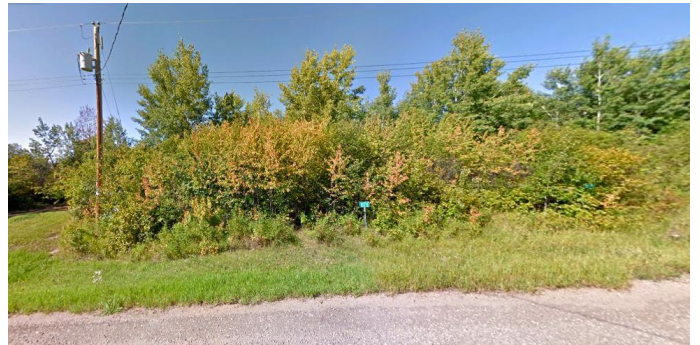

Essential Information

MLS® #	A2210631
Price	\$195,000
Bathrooms	0.00
Acres	0.47
Type	Land
Sub-Type	Residential Land
Status	Active

Community Information

Address	1074, 67325 Churchill Park Rd
Subdivision	Lakeview Estate_LLBC
City	Lac La Biche County
County	Lac La Biche County
Province	Alberta
Postal Code	T0A 2C0

Additional Information

Date Listed	April 11th, 2025
Days on Market	113
Zoning	Country Residential

Listing Details

Listing Office	RE/MAX LA BICHE REALTY
----------------	------------------------

Data is supplied by Pillar 9â„¢ MLS® System. Pillar 9â„¢ is the owner of the copyright in its MLS® System. Data is deemed reliable but is not guaranteed accurate by Pillar 9â„¢. The trademarks MLS®, Multiple Listing Service® and the associated logos are owned by The Canadian Real Estate Association (CREA) and identify the quality of services provided by real estate professionals who are members of CREA. Used under license.