

# \$279,000 - 100081 Township Road 720, Beaverlodge

---

MLS® #A2247054

**\$279,000**

0 Bedroom, 0.00 Bathroom,  
Land on 2.79 Acres

NONE, Beaverlodge, Alberta

2.79+/- Acres. Great location East of the proposed Hospital and across from Old Town Estates to the South. This property is located in the County of Grande Prairie. There is power, a water well and a sewer system (that does not comply). Older home and outbuildings with not a lot of value. Value is in the land, location and the services. There is a million dollar view to the mountains.

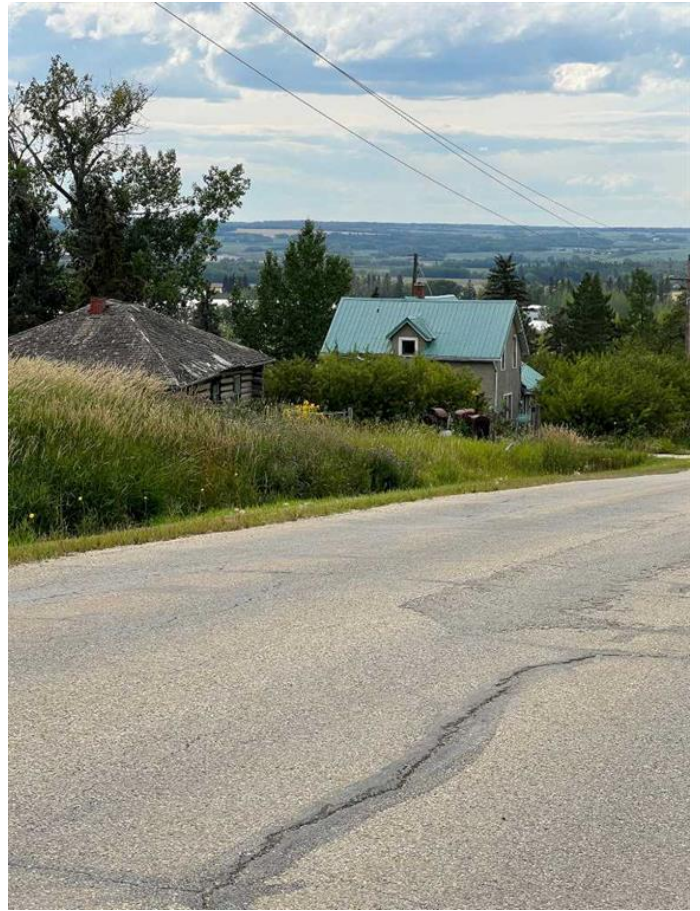

## Essential Information

MLS® #	A2247054
Price	\$279,000
Bathrooms	0.00
Acres	2.79
Type	Land
Sub-Type	Recreational
Status	Active

## Community Information

Address	100081 Township Road 720
Subdivision	NONE
City	Beaverlodge
County	Grande Prairie No. 1, County of
Province	Alberta
Postal Code	T0H 0C0

## Exterior

Exterior Features	Private Yard
-------------------	--------------

Lot Description      Corner Lot, Many Trees

Additional Information

Date Listed            August 8th, 2025  
Days on Market       2  
Zoning                  CR-5

Listing Details

Listing Office          All Peace Realty Ltd.

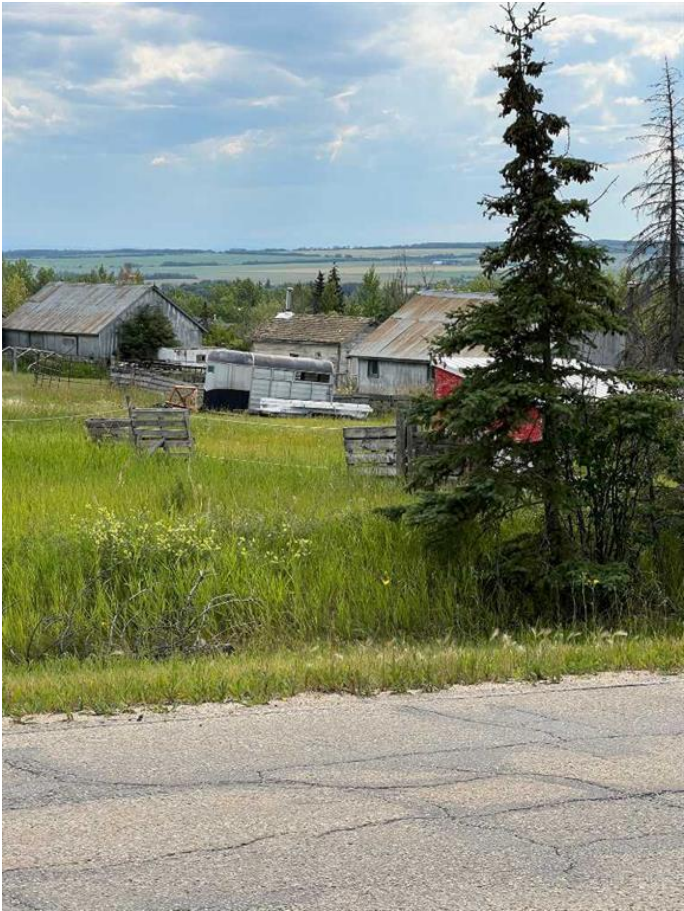

Data is supplied by Pillar 9a,ç MLSÂ® System. Pillar 9a,ç is the owner of the copyright in its MLSÂ® System. Data is deemed reliable but is not guaranteed accurate by Pillar 9a,ç. The trademarks MLSÂ®, Multiple Listing ServiceÂ® and the associated logos are owned by The Canadian Real Estate Association (CREA) and identify the quality of services provided by real estate professionals who are members of CREA. Used under license.

